

VARI®

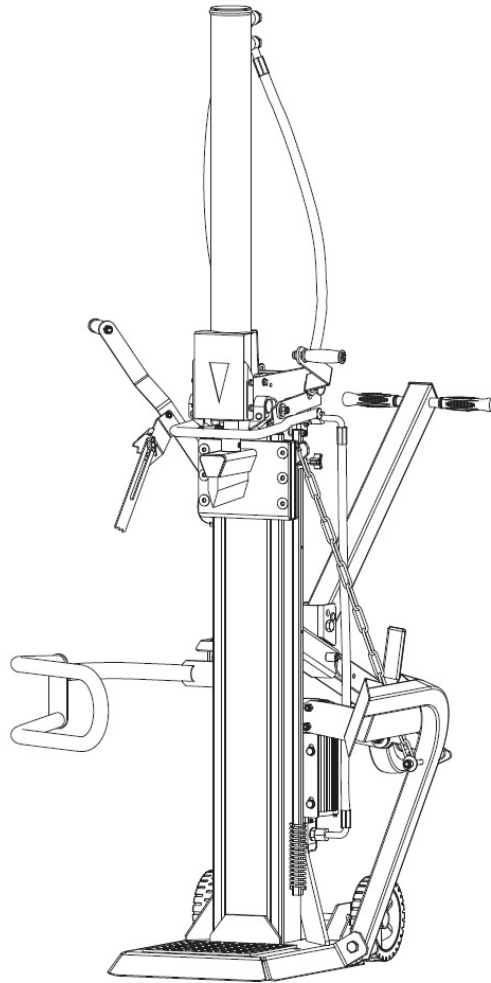

FOR YOUR SAFETY

**READ AND UNDERSTAND THE ENTIRE MANUAL
BEFORE OPERATING THE MACHINE**

MODEL: VARI 11 TON SUPER FORCE
VARI 14 TON SUPER FORCE
SERIAL NUMBER:

Both model number and serial number may be found on the main label.
You should record both of them in a safe place for future use.

Save This Manual for Future Reference

HYDRAULIC LOG SPLITTERS
Instructions for use (Original instructions for use) 2019

TABLE OF CONTENTS

INTRODUCTION	2
ENVIRONMENT	2
SYMBOLS	3
SAFETY	4
SPECIFICATIONS	8
APPLICATION CONDITIONS	8
ELECTRICAL REQUIREMENTS	8
CONTENTS SUPPLIED	9
ASSEMBLY	9
TRANSPORT	13
DELIVERING LOG SPLITTER TO WORK SITE	14
SPLITTER OPERATION	14
FREE A JAMMED LOG	18
REPLACING OIL	18
SHARPENING WEDGE	19
TROUBLESHOOTING	20
WIRING DIAGRAM	20
HYDRAULIC SYSTEM DIAGRAM	20
PART LIST	21
DISPOSAL OF PACKAGING AND MACHINE AFTER THE END OF SERVICE LIFE	23
INSTRUCTIONS FOR ORDERING SPARE PARTS	24
ADDRESS OF THE MANUFACTURER	24
ADDRESS OF THE IMPORTER AND DISTRIBUTOR	24
EC DECLARATION OF CONFORMITY	25

Edition 2019. The manufacturer reserves the right to introduce technical modifications and innovations, which do not affect the function and safety of the machine. These modifications may not necessarily be specified in this user manual. Printing errors reserved.

INTRODUCTION

Your new log splitter will more than satisfy your expectations. It has been manufactured under stringent quality standards to meet superior performance criteria. You will find your new unit easy and safe to operate, and with proper care, it will give you many years of dependable service.



Carefully read through this entire operator's manual before using your new log splitter. Take special care to heed the cautions and warnings.

ENVIRONMENT



Recycle unwanted materials instead of disposing of them as waste. All tools, hoses and packaging should be resorted, taken to the local recycling centre and disposed of in an environmentally safe way.

SYMBOLS

The rating plate on your machine may show symbols. These represent important information about the product or instructions on its use.



Read these instructions in full before using the machine.



Wear safety footwear!



Wear protective gloves!



Wear eye protection!
Wear hearing protection!



Keep your work space tidy!
Untidiness may result in accidents.



Do not remove or tamper with any protection or safety devices.



Dispose of the used oil in an environment-friendly way.



Do not use in the rain.



Danger! Keep clear of moving parts!



Do not remove jammed logs with your hands.



Caution! Thrown objects.



Before starting any repairs, maintenance or cleaning, always disconnect the power.



Avoid injury from the movement of the splitting blade.



Keep bystanders away from the working area.



Do not split wood when machine is transporting.



Do not split wood when machine is leaning.

SAFETY

SAFETY WARNINGS & INSTRUCTIONS

• UNDERSTAND YOUR LOG SPLITTER

Read and understand the owner's manual and labels affixed to the log splitter. Learn its application and limitations as well as the specific potential hazards peculiar to it. Be thoroughly familiar with the controls and their proper operation.

• DRUGS, ALCOHOL AND MEDICATION

Do not operate the log splitter while under the influence of drugs, alcohol or any medication that could affect your ability to use it properly.

- **AVOID DANGEROUS CONDITIONS**

Always operate your log splitter on dry, solid, level ground. Never operate your log splitter on slippery, wet, muddy or icy surfaces. The location you choose should be free from any tall grass, brush or other interferences. There should be plenty of room for handling, and help the operator stay alert. Keep your work area clean and well lighted. Cluttered areas invite injuries. To avoid tripping, do not leave tools, logs or other components lying around the work area. Do not use the log splitter in wet or damp areas or expose it to rain. Do not use it in areas where fumes from paint, solvents or flammable liquids pose a potential hazard.

- **INSPECT YOUR LOG SPLITTER**

Check your log splitter before turning it on. Keep guards in place and in working order. Form a habit of checking to see that keys and adjusting wrenches are removed from tool area before turning it on. Replace damaged, missing or failed parts before using it. Make sure all nuts, bolts, screws, hydraulic fittings, hose clamps, etc. are securely tightened. Always check the oil level in the hydraulic oil tank. Never operate your log splitter when it is in need of repair or is in poor mechanical condition. Before starting work, test the stopping devices to keep them in safe working condition.

- **DRESS PROPERLY**

Do not wear loose clothing, gloves, neckties or jewellery (rings, wrist watches). They can be caught in moving parts. Protective, electrically non-conductive gloves, non-skid footwear and hearing protection are recommended when working. Wear protective hair covering to contain long hair, preventing it from get caught in machinery.

- **PROTECT YOUR EYES AND FACE**

Any log splitter may throw foreign objects into the eyes. This can cause permanent eye damage. Always wear safety goggles. Everyday eyeglasses have only impact resistant lenses. They are not safety glasses.

- **EXTENSION CORDS**

Improper use of extension cords may cause inefficient operation of the log splitter, which can result in overheating. Be sure the extension cord is not longer than 10 m and its section is not less than 2,5 mm² to allow sufficient current flow to the motor. Avoid use of free and inadequately insulated connections. Connections must be made with protected material suitable for outdoor use.

- **AVOID ELECTRICAL SHOCK**

Check that the electric circuit is adequately protected and that it corresponds with the power, voltage and frequency of the motor. Check that there is a ground connection. Ground the log splitter. Prevent body contact with grounded surfaces: pipes, radiators, ranges, and refrigerator enclosures. Never open the switch / plug box. Should this be necessary, contact a qualified electrician. Make sure your fingers do not touch the plug's metal prongs when plugging or unplugging the log splitter.

- **PREVENT FIRES**

Do not smoke or have open flames when operating or refilling the log splitter. Never operate the log splitter near a flame or candle. Oil is flammable and can explode.

- **KEEP BYSTANDERS AWAY**

Allow only one person to load and operate the log splitter. Always keep bystanders, including visitors, children and pets away from the work area, especially when the log splitter is under operation. Only the operator should stand near the machine and only within the safe operating area prescribed in this manual. Never use another person to help you with freeing a jammed log. No one under the age of 16 should be allowed to operate the log splitter. Any individual under the age of 18 should have the necessary training, skills to perform the functions properly and safely and should always be under the supervision of an adult.

- **INSPECT YOUR LOG**

Never attempt to split logs containing nails, wire or debris. Always make sure that both ends of the log you are splitting are cut as square as possible. This will prevent the log from sliding out of position while under pressure. Branches must be cut off the trunk.

- **DON'T OVERREACH**

Keep proper footing and balance at all times. Never stand on the log splitter. Serious injury could occur if the tool is tipped or if the cutting tool is unintentionally contacted. Do not store anything above or near the log splitter where anyone might stand on the tool to reach it.

- **AVOID INJURY FROM UNEXPECTED ACCIDENT**

Do not straddle or reach across the splitting area when operating the log splitter. Never pile logs to be split in a manner that will cause you to reach across the log splitter. Only use your hands to operate the control levers. Never use your foot, knee, a rope or any other extension device. Always pay full attention to the movement of the wedge ram. Never attempt to load your log splitter while the ram is in motion. Keep hands out of the way of all moving parts. Never try to split two logs on top of each other. One of them might fly up and hit you.

- **PROTECT YOUR HANDS**

Keep your hands away from splits and cracks which open in the log. They may close suddenly and crush or amputate your hands. Do not remove jammed logs with your hands.

- **DON'T FORCE TOOL**

It will do a better and safer job at its design rate. Don't use the log splitter for a purpose for which it was not intended. Do not alter the equipment, or use the equipment in such a way as to circumvent its design capabilities and capacities. Never try to split logs larger than those indicated in the specifications table.

- **DISCONNECT POWER**

Unplug when not in use, before making adjustments, changing parts, cleaning or working on the log splitter. Consult the technical manual before servicing.

- **MAINTAIN YOUR LOG SPLITTER WITH CARE**

Before cleaning, repair, inspecting or adjusting, shut off the machine and make certain all moving parts have stopped. Always clean the unit after each use. Keep the log splitter clean for best and safest performance. Follow instructions for lubricating. Inspect all hydraulic seals, hoses and couplers for leaks prior to use. Control levers and power switch must be kept clean, dry and free from oil and grease at all times.

- **PROTECT THE ENVIRONMENT**

Take used oil to an authorized collection point or follow the stipulations in the country where the log splitter is used. Do not discharge into drains, soil or water.

- **MAKE THE WORKSHOP CHILDPROOF**

Lock the shop. Store the log splitter away from children and others not qualified to use it.

- **DEAL WITH ACCIDENT**

Always have a fire extinguisher and a first aid kit available for use should the need arise. In emergency always know the location of the nearest phone or keep a phone on the job site. Also know the phone numbers of the nearest ambulance, doctor and fire department. This information will be invaluable in the case of an emergency.

- **SPECIAL WARNING**

- The splitting operation of the machine is designed to be activated by one person. While there is the possibility that additional operators could be working with the machine (e.g. for loading and unloading), only one operator should activate splitting operations;
- The machine shall not be used by children;
- Description of functional tests of the machine;
- The installation and maintenance requirements including a list of those devices e.g. two-hand control device which should be verified, how frequently the verification shall be carried out and by what method.

SPECIFICATIONS

Model		65710	65715
Trade Name		VARI 11 TON SUPER FORCE	VARI 14 TON SUPER FORCE
Motor (S6 40 %)*		400 V 3~ 50 Hz 3300 W 5,3 A	400 V 3~ 50 Hz 3500 W 7,1 A
Log Size Capacity	Diameter	10-30 cm	
	Length	56-104 cm	
Maximum Force		11 t ± 10 %	14 t ± 10 %
Hydraulic Pressure		25,5 MPa	24,6 MPa
Hydraulic Oil Capacity		7,0 l	7,5 l
Ram Travel		85 cm	
Speed	Forward	23,2 cm/s	21,8 cm/s
	Retract	4,9 cm/s	4,2 cm/s
Noise Pressure Level (LpA)		6,1 cm/s	
Vibration		5,2 cm/s	
Overall Sizes	Length	144 cm	144 cm
	Width	133 cm	135 cm
	Height	228 cm	228 cm
Weight		172,5 kg	184,9 kg

* S6 40%, continuous operation periodic duty: time of one load cycle is 10 minutes, operation time at constant load is 4 minutes, operation time at no-load is 6 minutes.

APPLICATION CONDITIONS

This log splitter is designed for operating under ambient temperatures between +5°C and +40°C and for installation at altitudes not more than 1000 m above M.S.L. The surrounding humidity should be less than 50 % at 40°C. It can be stored or transported under ambient temperatures between -25°C and +55°C.

ELECTRICAL REQUIREMENTS

With 3 phase 400 Volt / 50 Hz motor, the log splitter should be connected to standard 400 V ± 10 % / 50 Hz ± 1 Hz electrical supply which has protection devices of under-voltage, over-voltage, over-current as well as a residual current device (RCD) with maximum residual current rated at 0,03 A.

The mains connection and extension cable must have 5 wires = 3P + N + PE (3/N/PE). The mains connection must have maximum 16 A fuse. Electrical connection rubber cables must comply with IEC 60245, which is always marked with symbol H 07 RN. Cables should be identified, as it is a legal requirement. The cable is not supplied with the machine.

CONTENTS SUPPLIED

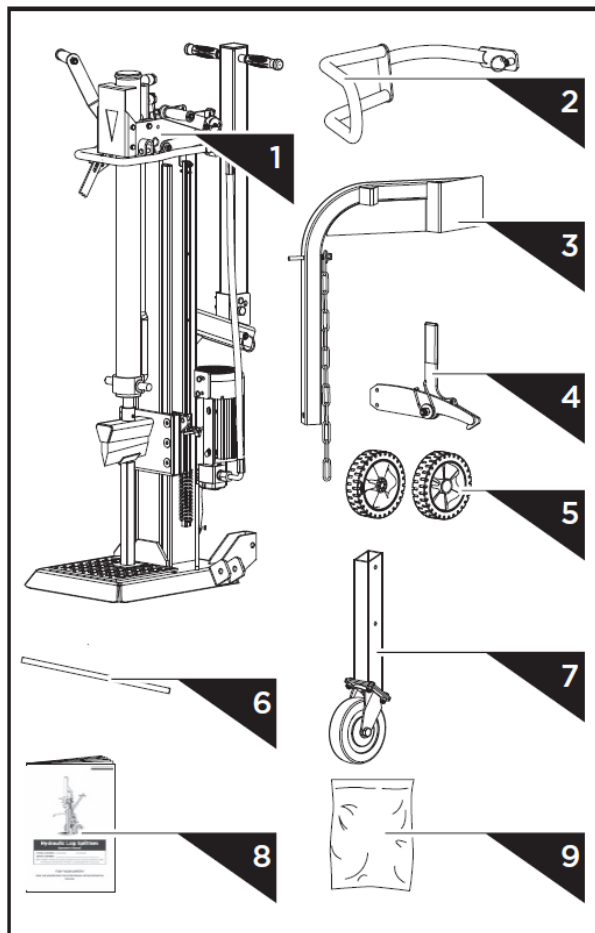

5. Wheel
6. Wheel axle
7. Support wheel
8. Operator's manual
9. Hardware bag, including

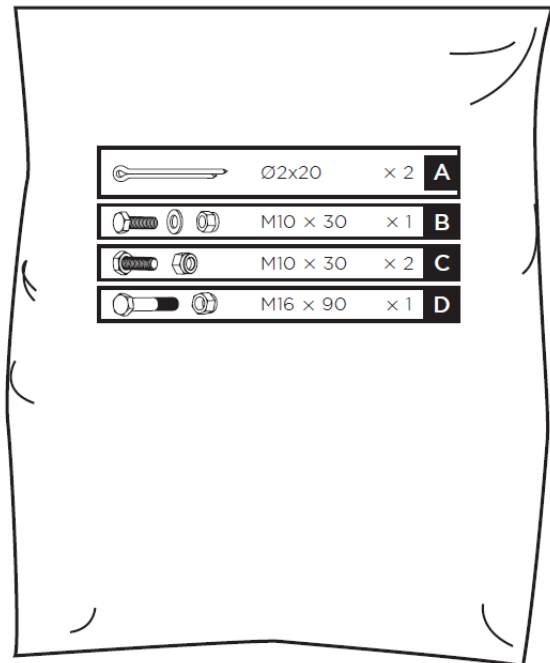

1. Log splitter frame & power station
2. Guard arm
3. Log lift
4. Retaining hook

ASSEMBLY

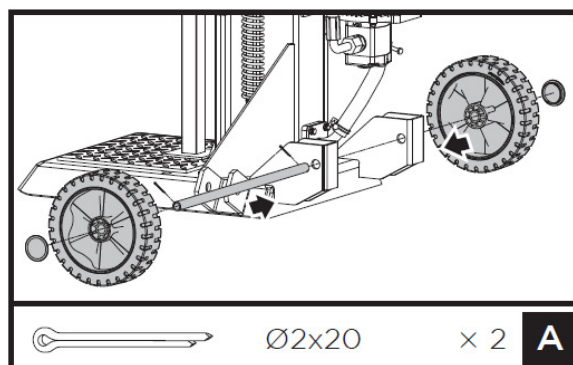

1. Insert the wheel axle into the holes of the mount bracket. Slide the wheels onto the axle and secure with Ø2x20 split pins from outside. Attach the wheel caps.

2. Keeping the support stand against the wedge, remove the R-Pin and bolt to release cylinder. Lower both control handles to raise the wedge ram to the top. Insert the bolt and R-pin to secure the cylinder.

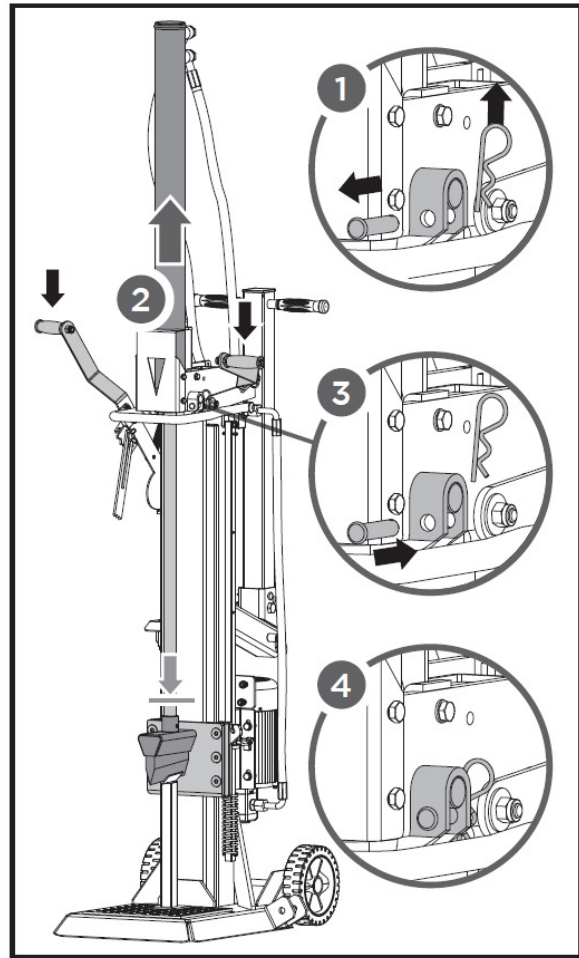

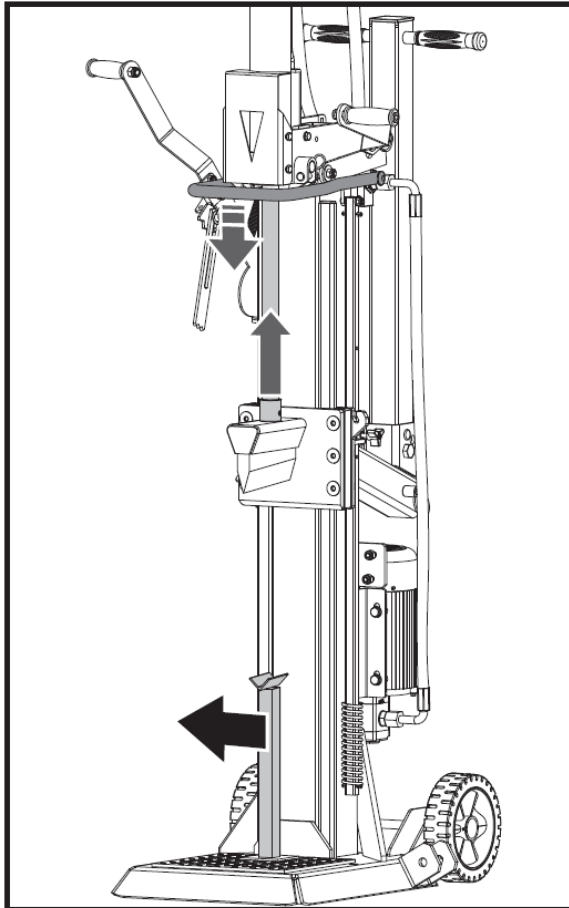

3. Release both control handles to retract the wedge ram. Remove the support stand.

4. Align the hole and locking pin of the guard arm with the mount bracket. Secure the guard arm with an M10x30 hex bolt, a washer and a nut from the hardware bag.

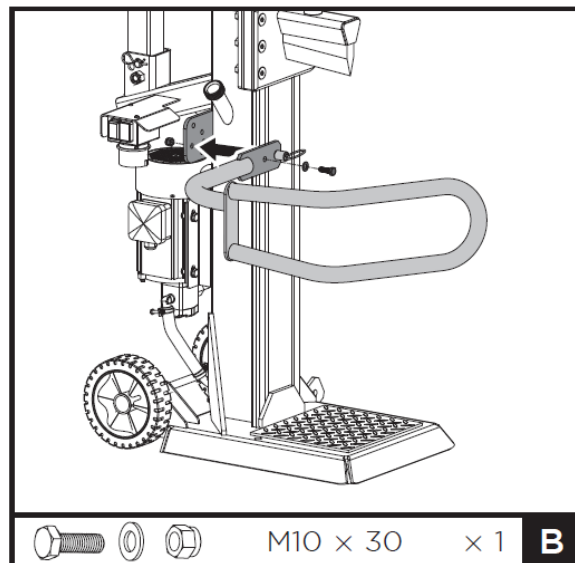

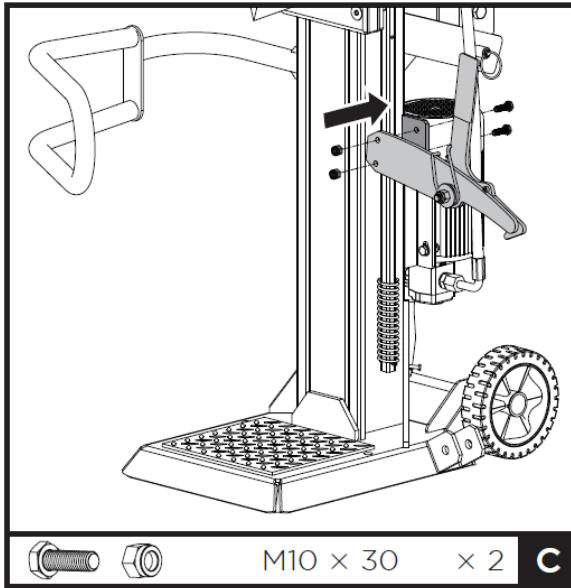

5. Position the retaining hook onto the frame and secure with two M10x30 hex bolts and nuts.

6. Position the log lift inside the mounting bracket and align with mounting bracket holes. Secure with an M16x90 hex bolt and nut. Hook the lift chain to wedge slide guide.

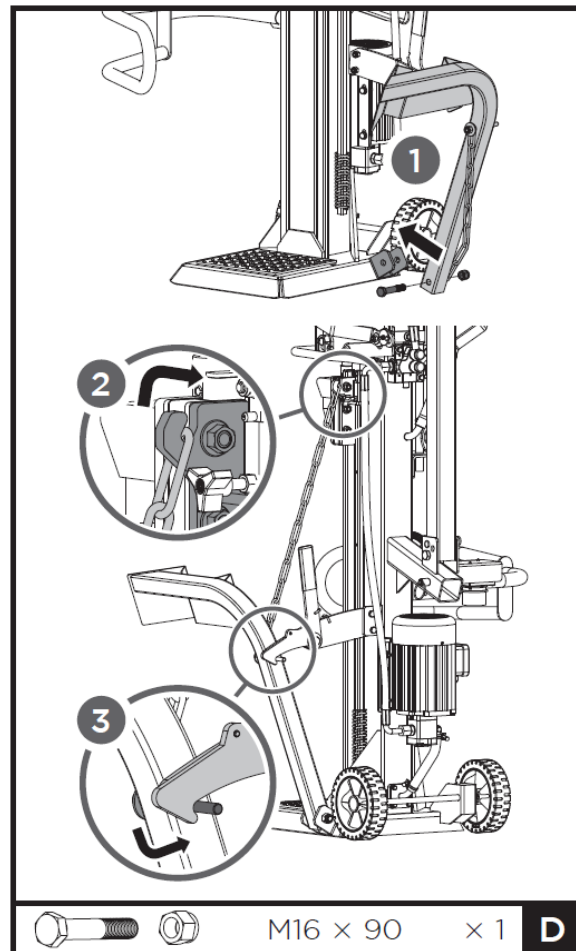

TRANSPORT

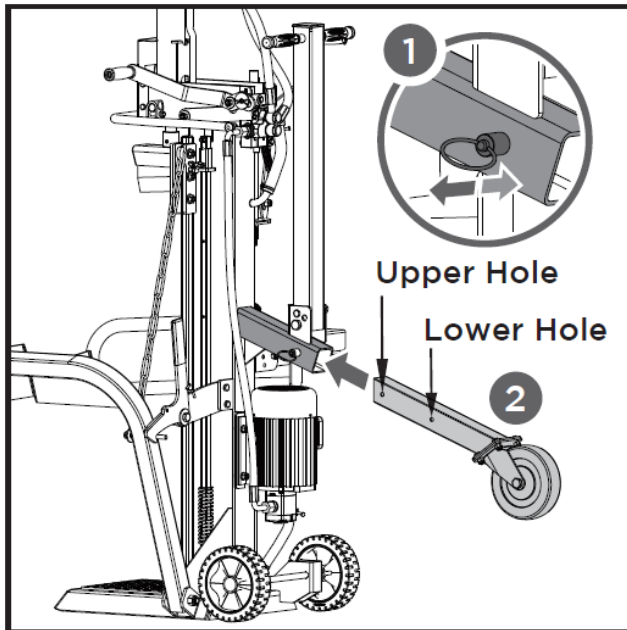

Pull the spring pin and slide the square tube of the support wheel into the holder. Loosen the spring pin to fix it after selecting the appropriate hole.



The upper hole is for transport and lower hole is only for storage. Because the support wheel is a universal wheel, it is not stable enough for transport if mounted at the lower hole!

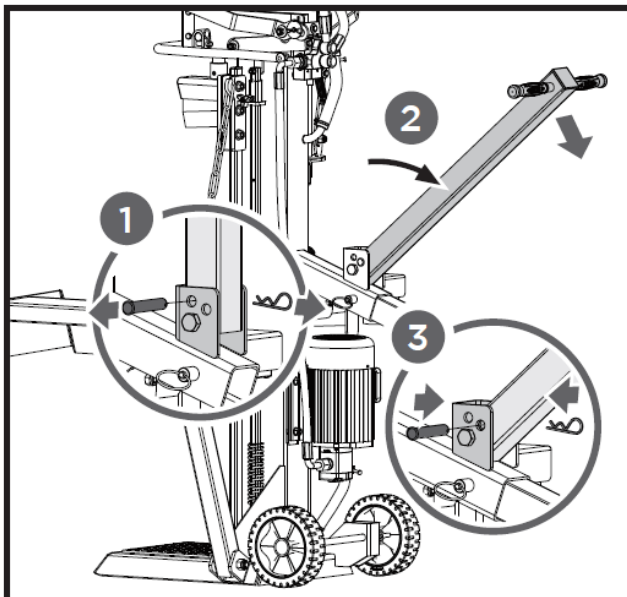

The transporting handle is fixed upright by the pin with clip for easier delivery.

Remove the clip and pin. Lower the handle in the direction of the arrow as shown and secure it by fixing the pin with clip to the outer hole.

DELIVERING LOG SPLITTER TO WORK SITE

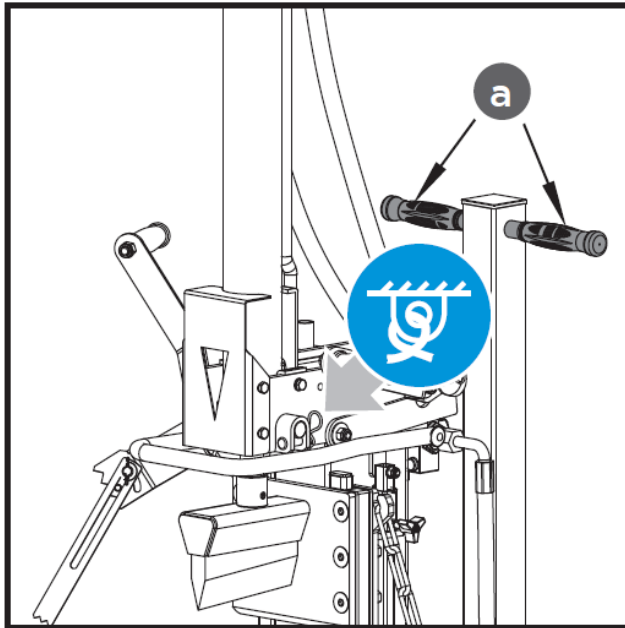

The log splitter is equipped with 2 wheels for minor moving. To move the log splitter to the work site, grip the handle (a) to tilt the log splitter slightly after making sure the oil tank cover is tightened.

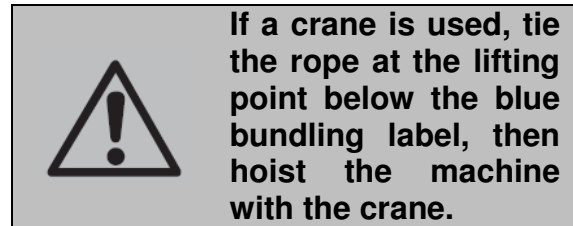

SPLITTER OPERATION

Plan your work site. Work safely and save effort by planning your work beforehand. Have your logs positioned where they can be easily reached. Have a site located to stack the split wood or load it onto a nearby truck or another carrier. Position the log splitter on solid level ground.

Applying a thin coat of grease to the surfaces of the ram before operation will lengthen the durability of the ram.

Bleed the air out of the hydraulic system before starting the log splitter. The cover of the hydraulic oil tank should be loosened by some rotations until air can go in and out of the oil tank smoothly.

Air flow thru the oil tank filler should be detectable during the operations.

Before moving the log splitter, make sure the cover of the oil tank is tightened to avoid oil leaking from this point.

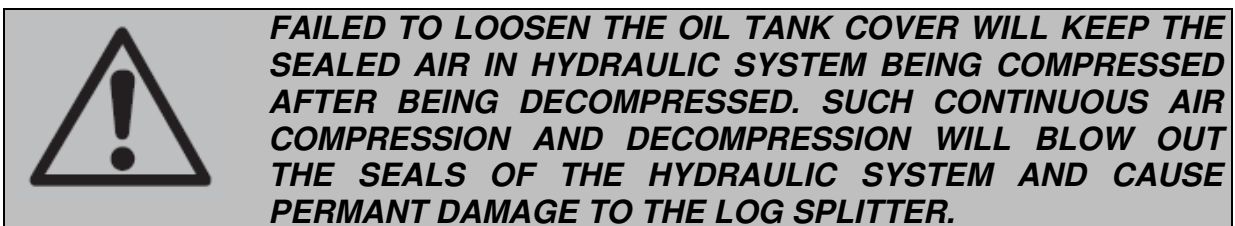
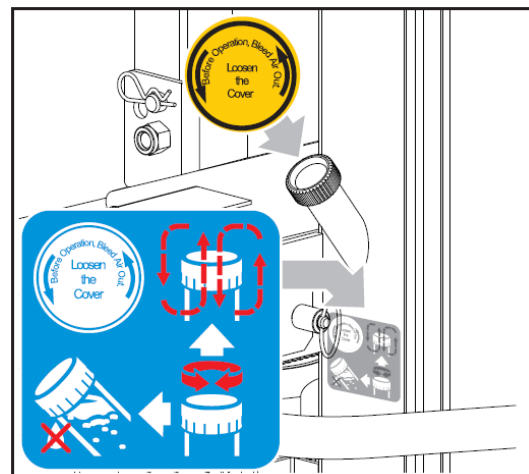

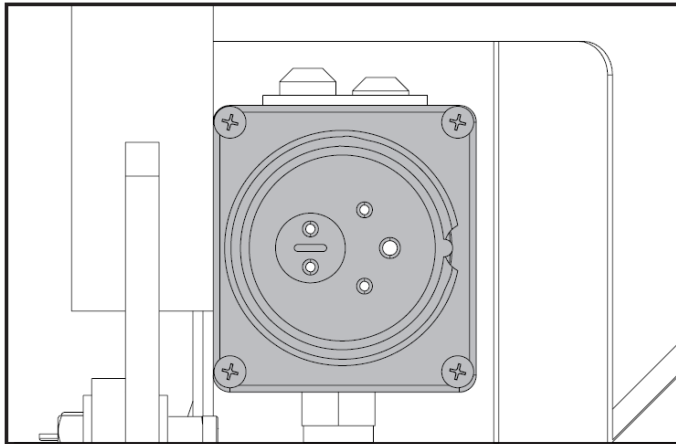

Turn the motor switch to the ON position to start the log splitter. To stop the machine, just turn the motor switch to the OFF position.



Make sure the direction of motor rotation is correct. Turn the motor on; the wedge ram should rise to the highest position automatically. If the wedge ram is already at the highest position when the motor starts, grip both control levers and lower them, the wedge ram should start to move downward.

If no ram motion is detected after the motor starts, power off the motor immediately to change motor polarity by turning the pole switching device inside the plug with a screwdriver.

400 V 3N

Never allow motor running at counter direction. This will damage the pump and will void the warranty.

Splitting

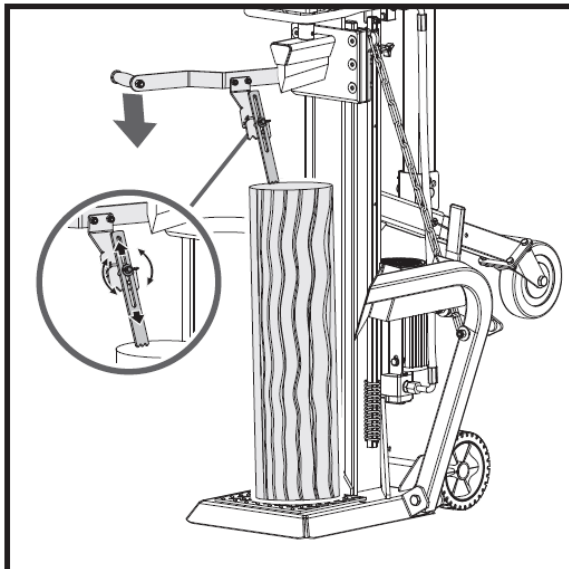

1. Place the log vertically on the support table, so that it lies flat on its face. Press the left lever to lower the extended log fixing claw against the log to secure it. The extended log fixing claw can be adjusted to fit logs with different heights.

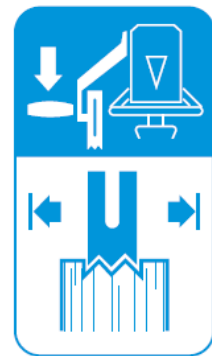

2. Hold the left press lever. Meanwhile, move the splitter wedge down by pressing the right splitting lever to the half stroke to split the log slowly first and then press it to the end until the log is completely split.

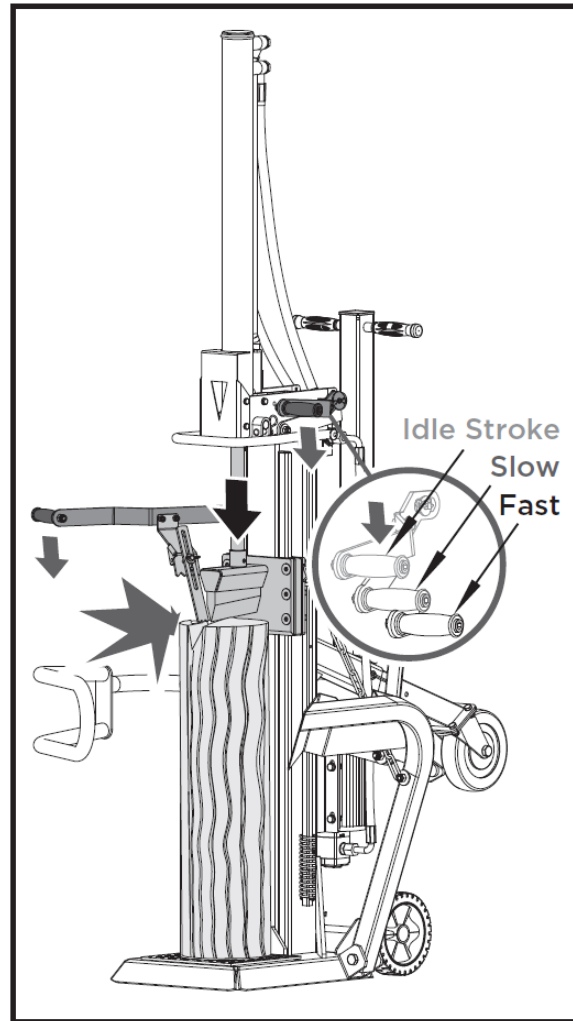
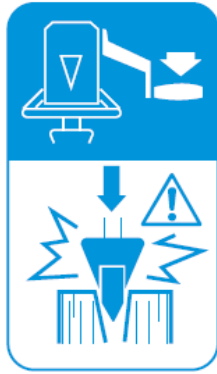

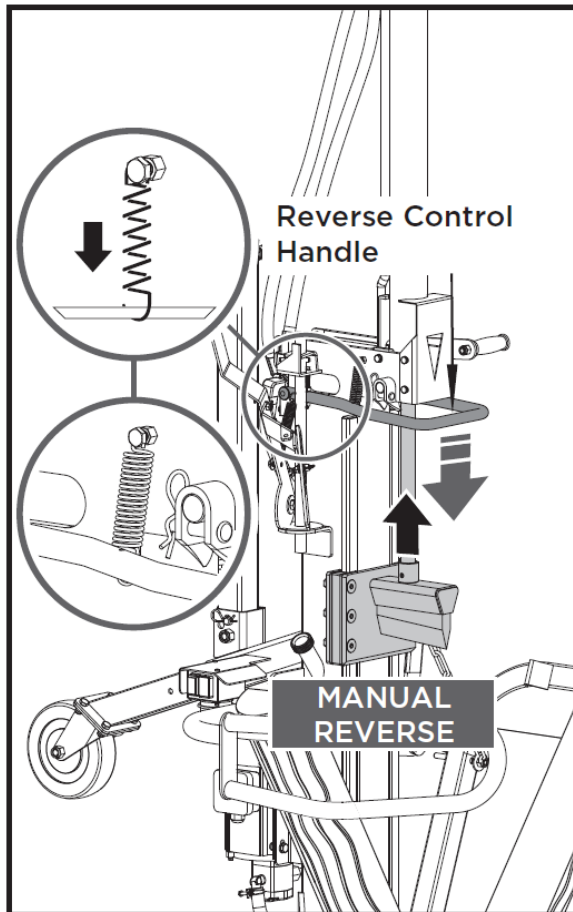

- Return the splitter wedge to the starting position. Operate the spring-loaded retract control lever to lift wedge above the height of log to be split.

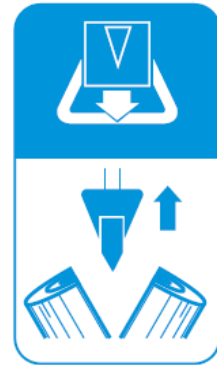

The spring is already connected to the handle in factory.

Splitting Lever

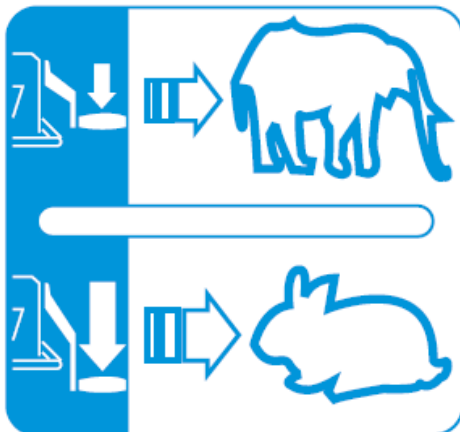

The splitting force and speed are governed by the splitting lever.

The first half stroke of the splitting lever is idle speed; press the splitting lever to the half stroke for maximum splitting force at slower speed to split the log at the beginning or particularly hard and seasoned logs.

Press the splitting lever to the end for faster speed at less splitting force to finish the splitting or to split usual logs.

It can be shifted by simply raising and lowering the splitting lever slightly.



Do not attempt to split green logs. Dry, seasoned logs split much more easily, and will not jam as frequently as green wood.



Break log in the direction of its growing grain. Do not place log across the log splitter for splitting. It may be dangerous and may seriously damage the machine.



Do not remove jammed logs with your hands. Never use another people to help you with freeing jammed log.

Stack as you work. This will provide a safer work area, by keeping it uncluttered, and avoid the danger of tripping, or damaging the power cord.



Accumulated split wood and wood chips can create a hazardous work environment. Never continue to work in a cluttered work area which may cause you to slip, trip or fall.

FREE A JAMMED LOG

Do not remove jammed logs with your hands. If jammed, stop the motor and loosen the log by a downward stroke on the log with a hammer.

REPLACING OIL

The hydraulic system is a closed system with oil tank, oil pump and control valve. Low oil levels can damage the oil pump. Check oil level regularly with dipstick. The oil should be completely changed once a year.

Following hydraulic oils or equivalent are recommend for the log splitter's hydraulic transmission system:

SHELL Tellus 22

MOBIL DTE 11

ARAL Vitam GF 22

BP Energol HLP-HM 22

Mogul/Paramo OTHP 3

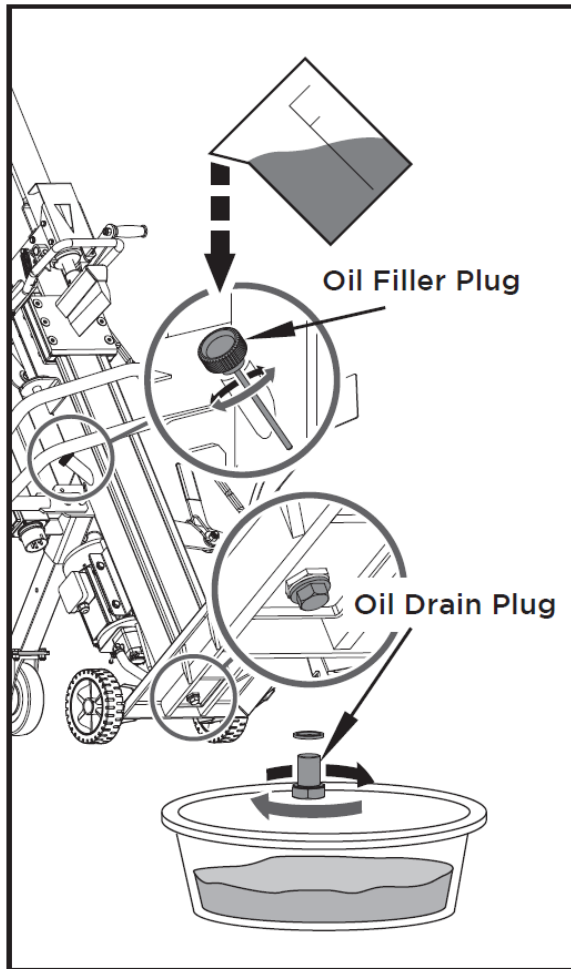

Use a drain pan to aid in the removal of all used oil and particles.

Remove oil drain plug to drain oil from the hydraulic transmission system. Examine oil for metal chips as a precaution to future problems.

After oil has been completely drained from the machine, reinstall drain plug.

Add the hydraulic transmission system with recommended oil through filler plug opening.

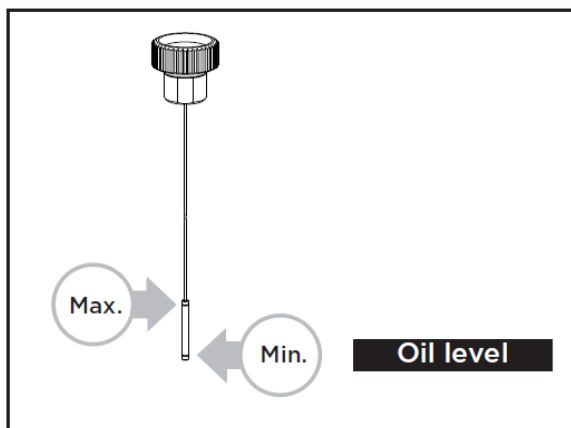

Read dipstick to determine the maximum and minimum of the oil level. Low oil can damage the oil pump. Overfilling can result in excessive temperature in the hydraulic transmission system.

Apply sealant to filler plug and reinstall it.

Following an oil change, activate the log splitter a few times without actually splitting.

SHARPENING WEDGE

This log splitter is equipped with reinforced splitting wedge which blade is specially treated. After long periods of operation, and when required, sharpen the wedge using a fine-toothed file removing any burrs or flat spots on the edge.

TROUBLESHOOTING

PROBLEM	PROBABLE CAUSE	REMEDY SUGGESTED
Motor does not start	Switch is OFF	ON the switch
Incorrect motor rotation direction	Incorrect connection	Change pole switching device in the plug with a screwdriver
		Reverse polarity by electrician
Log Splitter does not work while motor running	Valve is not opened owing to the connection parts loosening	Check and tighten the parts
	Control Levers or connection parts bent	Repair the bent parts
	Lower hydraulic oil level	Check and refill hydraulic oil
Log Splitter works with abnormal vibration and noise	Lower hydraulic oil level	Check and refill hydraulic oil



ATTENTION: ALL REPAIR WORK MUST BE DONE BY A SPECIALIST FOR THIS PRODUCT.

WIRING DIAGRAM

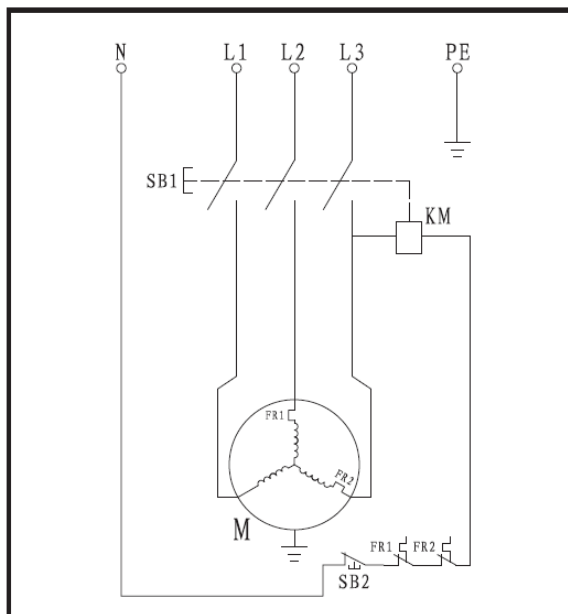

HYDRAULIC SYSTEM DIAGRAM

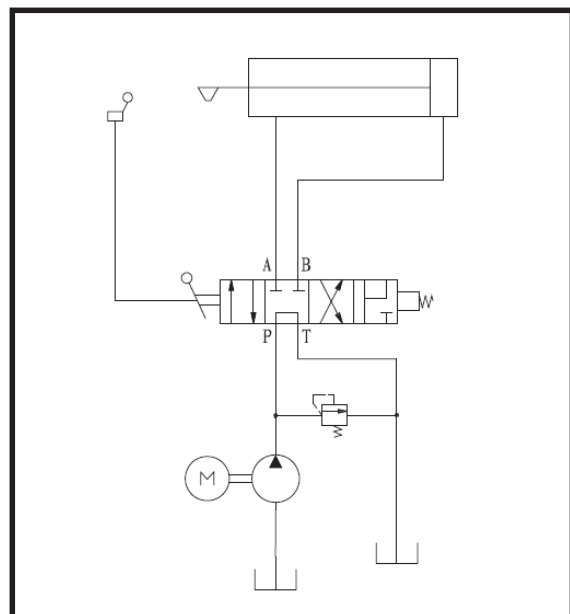

PART LIST

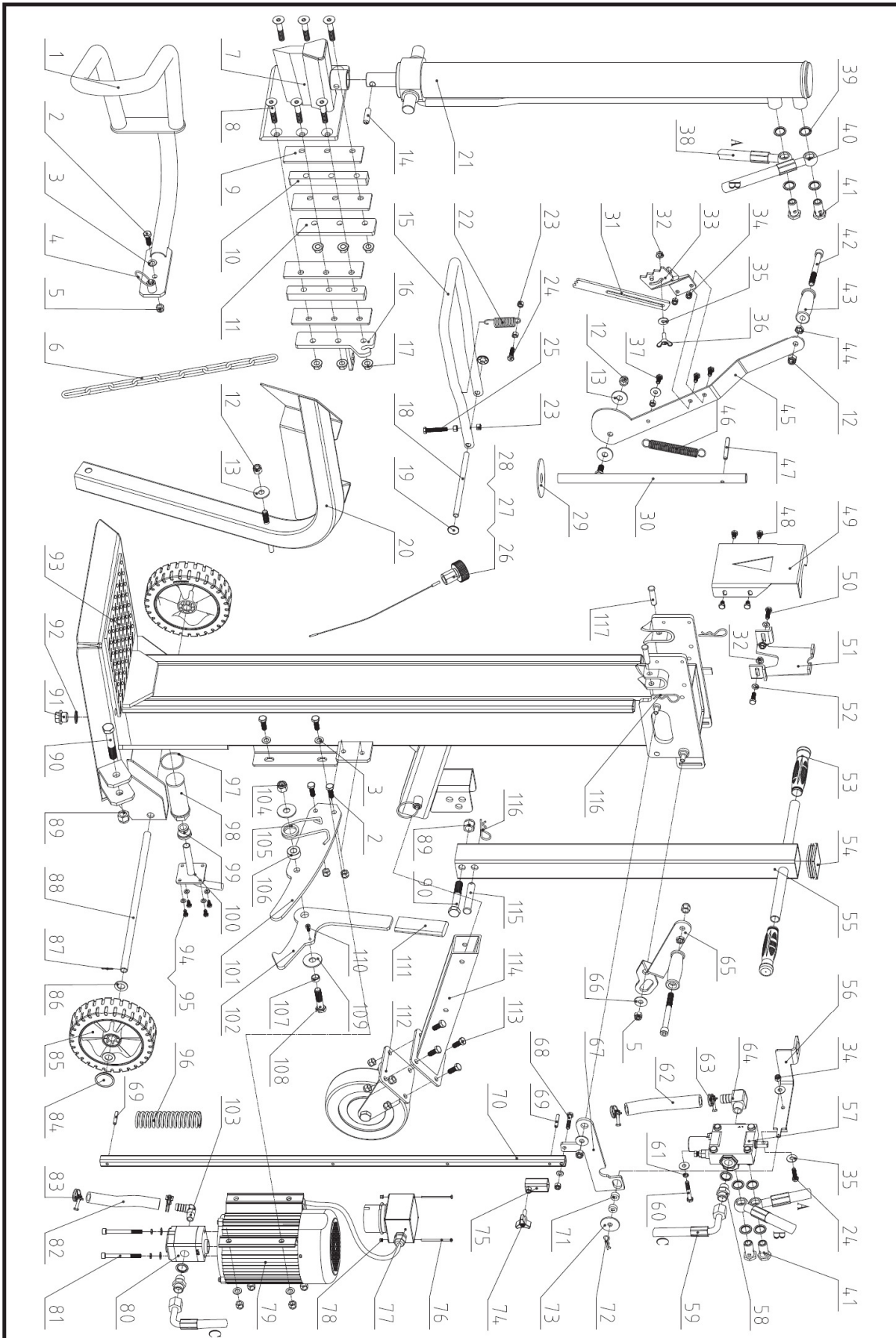

Pos.	Part No.	Name	Pcs	Pos.	Part No.	Name	Pcs
1	211001	Left guard bracket	1	39	211039	Combined washer 10	10
2	211002	Bolt M10x30	7	40	211040	Upper hose	1
3	211003	Flat washer 10	9	41	211041	Valve connector	4
4	211004	Locating pin handle	2	42	211042	Screw M12x120	2
5	211005	Locknut M10	13	43	211043	Operating handle grip	2
6	211006	Lift chain ø6	1	44	211044	Thin nut M12	2
7	211007A	Wedge weldment 11 ton	1	45	211045	Lever	1
7	211007B	Wedge weldment 14 ton	1	46	211046	Reset spring	1
8	211008	Bolt M12x65	6	47	211047	Cylindrical pin 8x60	1
9	211009	Friction plate	4	48	211048	Bolt M8x12	4
10	211010	Baffle plate	2	49	211049A	Front support plate for cylinder 11 ton	1
11	211011	Left plate	1	49	211049B	Front support plate for cylinder 14 ton	1
12	211012	Locknut M12	4	50	211050	Bolt M8x25	2
13	211013	Large washer 12	3	51	211051A	Rear support plate for cylinder 11 ton	1
14	211014	Cylindrical pin 8x40	1	51	211051B	Rear support plate for cylinder 14 ton	1
15	211015	Control U-handle	1	52	211052	Flat washer 8	3
16	211016	Right plate	1	53	211053	Handle grip	1
17	211017	Nut M12	6	54	211054	Square plug	1
18	211018	Axis pin	1	55	211055	Pull rod	1
19	211019	Cap 12	2	56	211056A	Connecting plate for valve 11 t	1
20	211020	Lift guard	1	56	211056B	Connecting plate for valve 14 t	1
21	211021A	Cylinder 11 ton	1	57	211057	Valve	1
21	211021B	Cylinder 14 ton	1	58	211058	Hose nipple	2
22	211022	Spring	1	59	211059	Inlet hose	1
23	211023	Nut M8	5	60	211060	Bolt M8x50	2
24	211024	Bolt M8x30	2	61	211061	Spring washer 8	4
25	211025	Bolt M8x80	1	62	211062	Oil hose 19	1
26	211026	Oil cap	1	63	211063	Hose clamp 28-36	2
27	211027	O-ring 25x2,65	1	64	211064	Hose connector	1
28	211028	Oil dipstick	1	65	211065	Right operating lever	1
29	211029	Nylon washer	1	66	211066	Large washer 10	2
30	211030	Shaft	1	67	211067	Connecting lever	1
31	211031	Extended log fixing claw	1	68	211068	Bolt M8x40	1
32	211032	Nut M8	3	69	211069	Cylindrical pin 6x40	2
33	211033	Log fixing claw	1	70	211070	Stroke adjusting lever	1
34	211034	Locknut M8	4	71	211071	Round plate	2
35	211035	Large washer 8	6	72	211072	Clip 2,5	1
36	211036	Wing bolt M8x25	1	73	211073	Large washer 10	1
37	211037	Bolt M8x20	3	74	211074	Star knob	1
38	211038	Lower hose	1	75	211075	Adjusting sleeve	1

Pos.	Part No.	Name	Pcs	Pos.	Part No.	Name	Pcs
76	211076	Screw M4x60	2	97	211097	O-ring 50x2,65	1
77	211077	Switch	1	98	211098	Oil filter K	1
78	211078	Locknut M4	2	99	211099	Bush K	1
79	211079A	Motor 11 ton	1	100	211100	Flange	1
79	211079B	Motor 14 ton	1	101	211101	Locating plate	1
80	211080A	Gear pump 11 ton	1	102	211102	Hook	1
80	211080B	Gear pump 14 ton	1	103	211103	Rectangular nozzle	1
81	211081	Screw M8x90	1	104	211104	Locknut M14	1
82	211082	Oil hose 16	1	105	211105	Torsional spring	1
83	211083	Hose clamp 20-26	2	106	211106	Locating bush for spring	1
84	211084	Wheel cap	2	107	211107	Locating bush	1
85	211085	Wheel	2	108	211108	Bolt M14x60	1
86	211086	Flat washer 16	4	109	211109	Large washer 14	2
87	211087	Cotter pin 2x20	2	110	211110	Screw M6x10	1
88	211088	Wheel axle	1	111	211111	Handle grip	1
89	211089	Locknut M16	2	112	211112	Support wheel assy.	1
90	211090	Bolt M16x90	2	113	211113	Bolt M10x25	4
91	211091	Screw plug	1	114	211114	Fixing tube	1
92	211092	Combined washer 22	1	115	211115	Pin B 16x85	1
93	211093	Main frame	1	116	211116	Clip 3	3
94	211094	Bolt M6x12	4	117	211117A	Pin B 12x50 (11 ton)	2
95	211095	Flat washer 6	4	117	211117B	Pin B 12x55 (14 ton)	2
96	211096	Buffer spring	1				

DISPOSAL OF PACKAGING AND MACHINE AFTER THE END OF SERVICE LIFE

After unpacking the machine, you are obliged to provide for the disposal of packaging material with taking into account the use of secondary raw materials according to the legislation valid in your country and with respect to the decrees of local town or municipal authorities.

The following procedure is recommended for machine disposal after the end of its service life:

1. Dismount all parts from the machine that can still be used.
2. Dismount plastic machine parts and parts made of non-ferrous metals. The dismantled machine remainder and the dismantled parts are to be disposed according to the legislation valid in your country and with respect to the decrees of local town or municipal authorities.
3. Regarding waste from the electrical device, use the opportunity of **return buy-out** in the shop, where you purchased the device (**points 1 and 2 are not valid in this case**).
4. The machine is in accordance with the RoHS Directive (2002/95/EC, 2002/96/EC, 2003/108/EC).



5. The product is in accordance with the requirements of the above-mentioned EC Directive regarding the quantities of forbidden dangerous substances.

This pictograph means that the product was introduced on the market after 13th September 2005 and shall not be disposed to a waste container or a dustbin.

INSTRUCTIONS FOR ORDERING SPARE PARTS

The following data are to be used for an easier identification when ordering the spare parts:

1. Machine type, engine type, machine serial number and year of manufacture;
2. Ordering number given by manufacturer and its name in the part list;
3. Number of ordered pieces separately for each item;
4. Precise address, telephone number, fax number or e-mail address;
5. Should you be uncertain about the correct identification of the component, send the damaged component either to the nearest service shop or directly to the manufacturer;
6. All components should be ordered in the nearest service shop or at your dealer's.

In the case of any confusions concerning the spare parts or technical issues, the VARI a.s. commercial, customer-service or technical departments are prepared to answer all your inquiries.

ADDRESS OF THE MANUFACTURER

TIYA Hydraulics Co., Ltd., Fuqian Street North, Gaoze, 262300 Wulian, Shandong, P. R. China; TIYA Hydraulics Co., Ltd. is a production facility of TIYA International Co., Ltd.

ADDRESS OF THE IMPORTER AND DISTRIBUTOR

VARI, a.s.	phone:	(+420) 325 637 276
Opolanska 350	fax:	(+420) 325 607 264
Libice nad Cidlinou	e-mail:	vari@vari.cz
CZECH REPUBLIC	internet:	http://www.vari.cz/
289 07		

EC DECLARATION OF CONFORMITY¹**We herewith declare**

that the following machine complies with the appropriate basic safety and health requirements of the EC Directive based on its design and type, as brought into circulation by us.

In case of alteration of the machine, not agreed by us, this declaration will lose its validity.

Description: Log Splitter
Type: 65710, 65715
Test report No.: 705201136302-03 & 17707249 004

Applicable EC Directives: EC Directive of Machinery 2006/42/EC
EC Low Voltage Directive 2014/35/EU
EC Council Directive 2014/30/EU Electromagnetic
Compatibility

Applicable Harmonized Standards: EN 60204-1:2006+A1:2009
EN 609-1:2017
EN 55014-1:2017
EN 55014-2:2015
EN 61000-3-2:2014
EN 61000-3-11:2000

Name of Company: TIYA International Co., Ltd.
Address: B12B, Shenye Center, 9 Shandong Road,
Qingdao, China
Tel: (532) 8582 3333
Fax: (532) 8582 4444

Name / Title: Yuan Yue
Director

Signature:



Place / Date: Qingdao, China / March 4th, 2019

¹ The original declaration of conformity as issued by the manufacturer of the product.